

BIMTech
ENGINEERING

Virtualised Engineering

No.1 St Ann Street
Manchester
M2 7LR

Tel: 0161 696 9869

Web: www.bimtech-eng.com

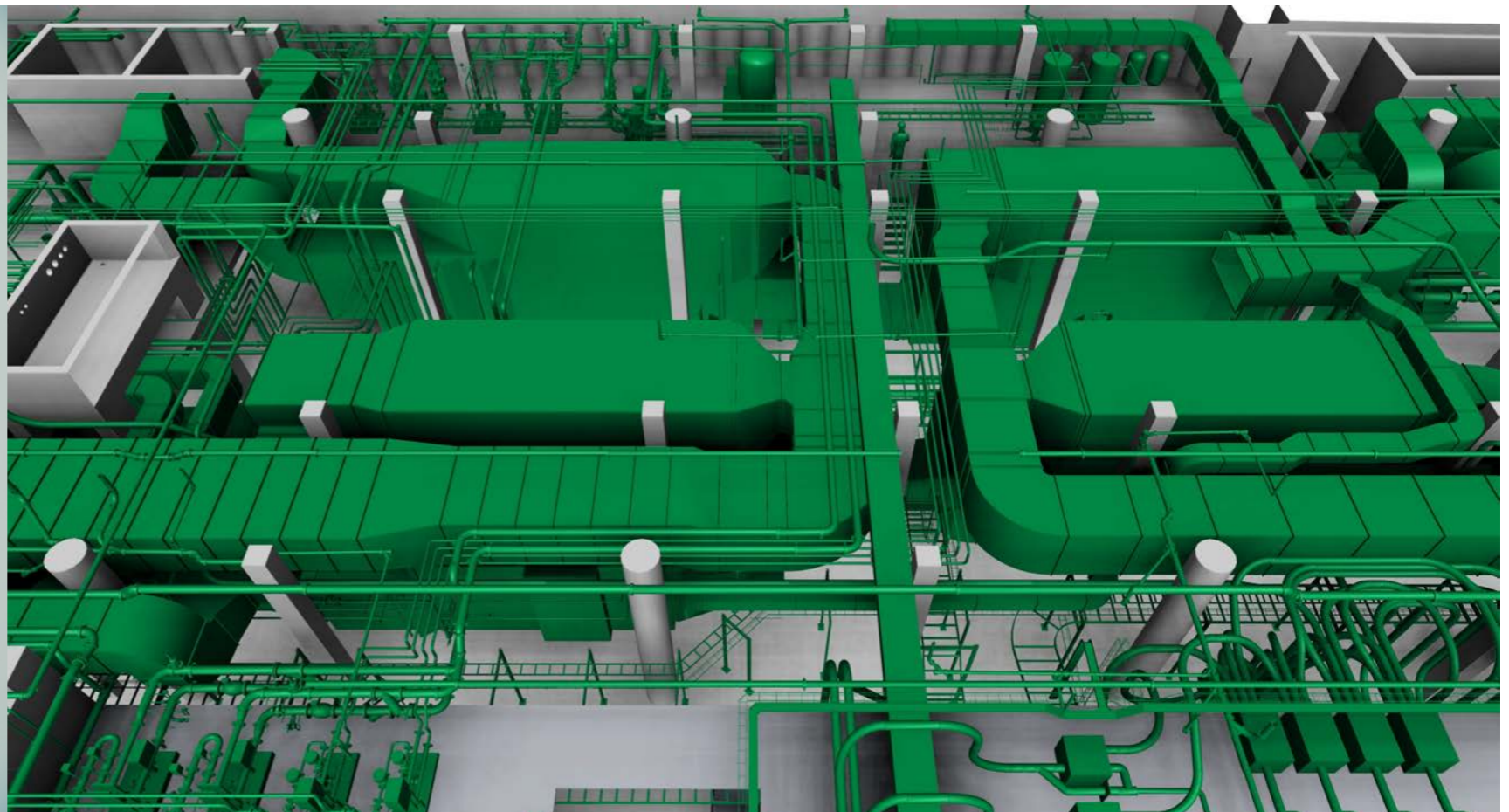

BIMTech are a specialised MEP virtual 3D modelling company that provide an integrated service for the provision of fully coordinated and clash detected mechanical, electrical and public health services drawings for the construction and infrastructure sectors.

We engage with our clients to apply proactive assistance for both conceptual and construction status engineering solutions, assessing equipment interface, safe access, operating/ maintenance requirements, multi-disciplinary coordination and alternative product selection to optimise 3D virtual model production.

Our highly experienced in-house team of technicians apply their extensive knowledge of the built environment to deliver coordinated models compliant with BIM Level 2 protocol and PAS 1192 requirements for data management.

BIMtech integrates with clients to challenge and drive information flow throughout the project, ensuring the optimum level of detail is achieved whilst meeting project timeline constraints.

Founded in 2005 as M&E Cad Services, BIMTech Engineering has secured and grown a highly experienced team of technicians that are proficient in 3D virtual modelling technology and the implementation of Building Information Modelling protocol now set to be the future standard for the construction sector.



BIMTech
ENGINEERING

Virtualised Engineering



BIMTech

The vision for the business is to embrace all emerging technologies for application in the built environment and provide a premier service that links the areas of concept and design with the needs of installers and operators to achieve construction standard coordinated information in compliance with Building Information Modelling protocol.

The company daily operations are run by Matt McGuire, who himself has 20 years experience in the production of MEP construction status information for a wide range of project applications and complexities.

With the change to **BIMTech** in 2015, Matt now has the support of his business partners who have significant experience within the construction sector from both project design, operational and commercial aspects, to compliment the business application, along with business organisational skills to provide company stability.

We will be expanding to a new facility located in Central Manchester planned for launch in October 2016.

This will create a modern studio environment for our team and the ability to expand the business to meet increasing demand.

The facility also has capacity to accommodate integrated client design team members at concentrated information transfer and checking phases of a project.



So where does **BIMTech** fit in to the MEP consultant role for design scope.

We recognise that as an MEP consultant you will be more than aware of the advent of Building Information Modelling, along with the Government Level 2 BIM Programme and the most recent Digital Built Britain Strategy which now sets out the advance to Level 3 protocol.

These strategies are set to continuously change the whole delivery profile of the construction sector and the first challenge is to **keep up with the journey**.

Getting left behind will in the short term begin to narrow participation in major projects and in the long term could mean a **complete loss of market position**.

The introduction of these new methods of working, along with the continuous development of the digital toolsets creates both **skill gaps and changes to working practices** within every business.



BIMTech

Implementation therefore needs to be phased and measured to ensure the impact of investment in the new methods of working do not damage the competitiveness and service levels already offered to clients.

An in-house capability would require investment in:

- New personnel**
- Training**
- Hardware**
- Software**
- Additional Office space**
- Additional Office Furniture**
- Time**



BIMTech can provide the leverage to balance the initial investment impact and support the VDC element of the BIM journey.

Ensuring the business offer can be flexed to meet both client demand and the ambition of your practice.



BIMTech

BIMTech have a wealth of knowledge embedded within its team ranging from the main business application of MEP services, through to Architectural and Civil Engineering degree level qualified technicians, modellers and engineers.

This wide range of experience allows the team to support each other and our customers in the understanding of the construction environment and apply a considered approach to the coordination of MEP disciplines with building structure and fabric.

There is **excellent collaboration within the business** and this is replicated with our clients to ensure solid working bonds within project design, pre-construction and delivery teams.

The BIMTech team are self confessed techno-junkies and thrive on the application of new technology, finding new hardware and software applications to improve the level of information and detail we can provide to our clients, with increasing efficiency and visual clarity.

We have a truly international team, ranging from the UK, South America, South Africa, Eastern and Southern Europe, that has integrated well by sharing the benefit from experience gained around the world in both training, education, work ethic and sector experience.



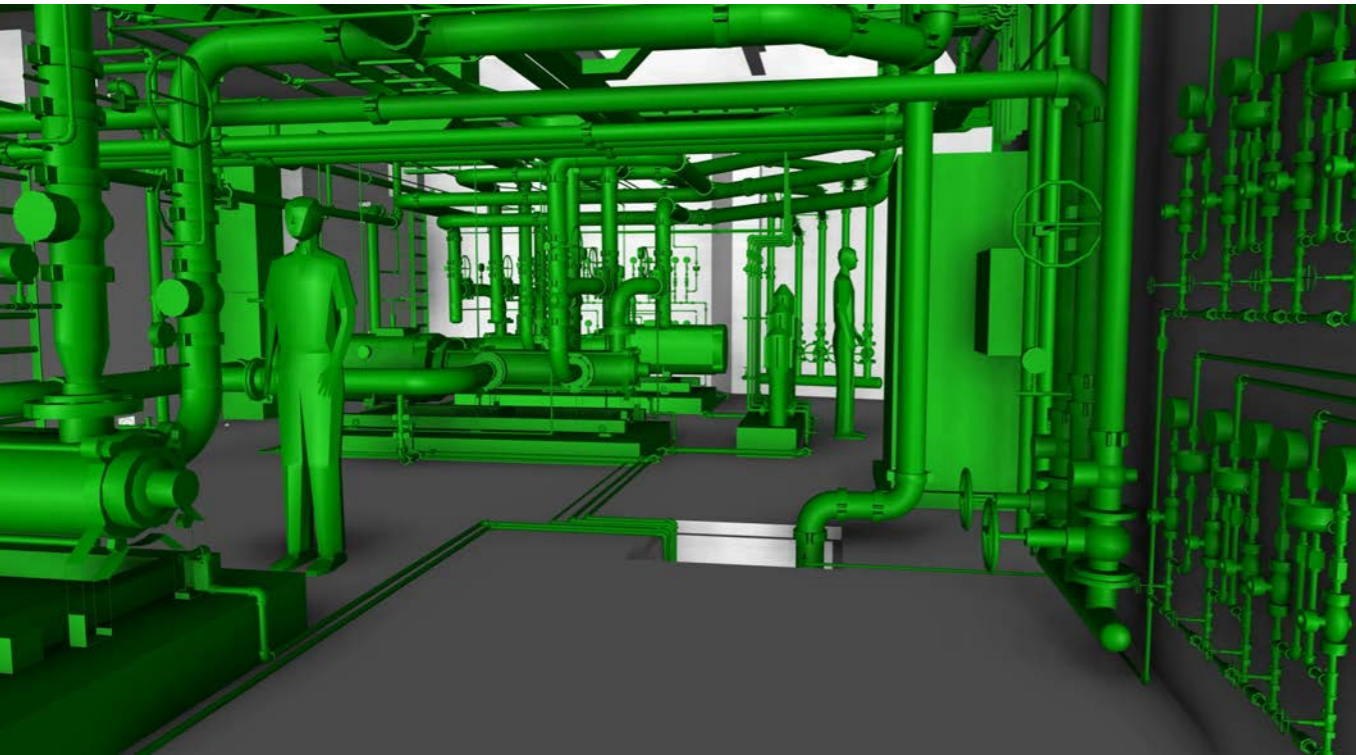

Utilising the experience we have gained in delivering VDC model information to **construction level detail** provides the capability for enhanced project communication and coordination during the design process.

Increasing the participation of the MEP design engineers in accurate design phase space allocation, considered product selection and definitive coordination of services distribution with structure and building fabric.

All elements that if left undefined will generate higher levels of technical queries, request for information and ultimately drive change at the pre-construction and construction stages of a project.

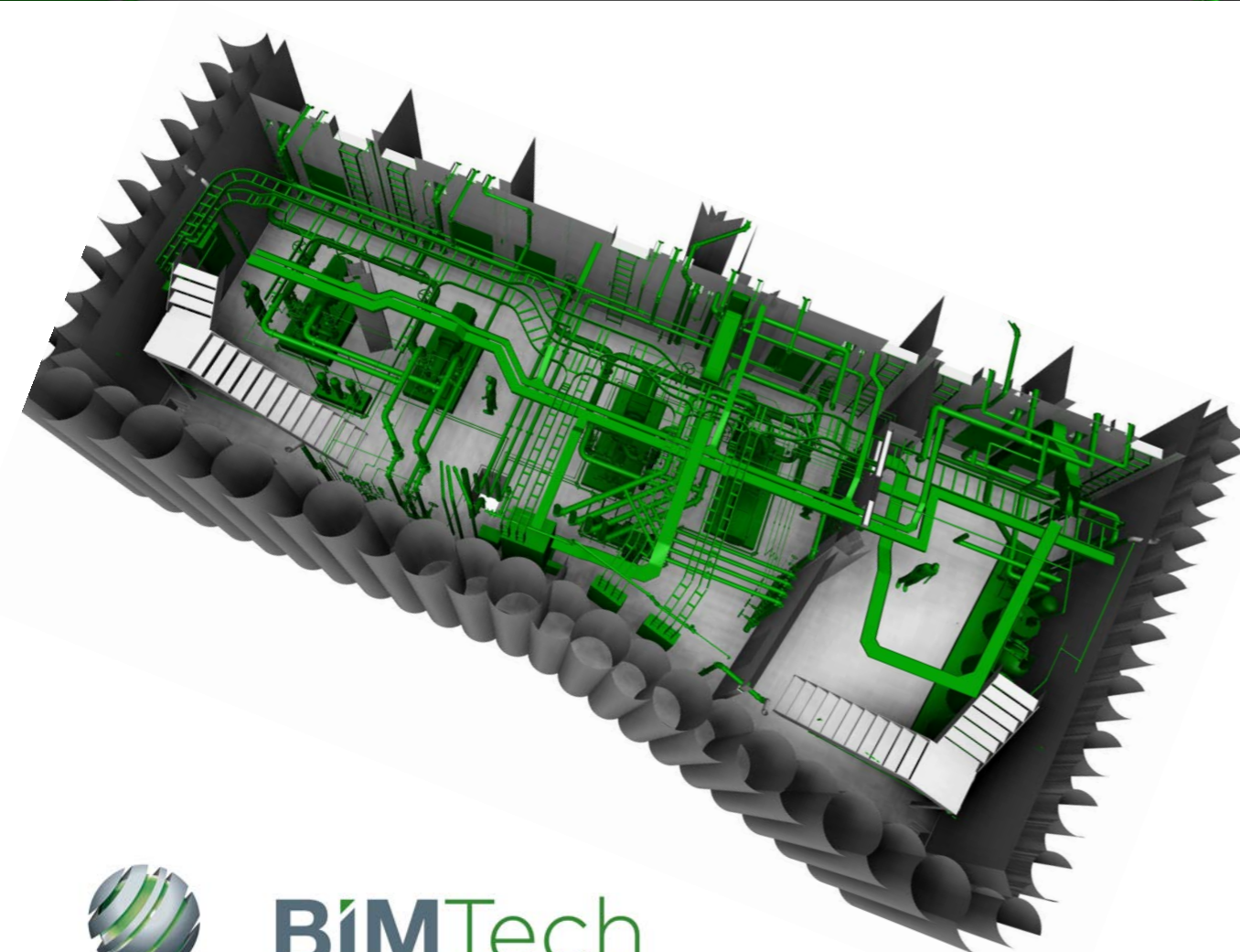

That change process ultimately impacts and resonates across the whole project team in terms of additional time, disruption and negative client reaction.

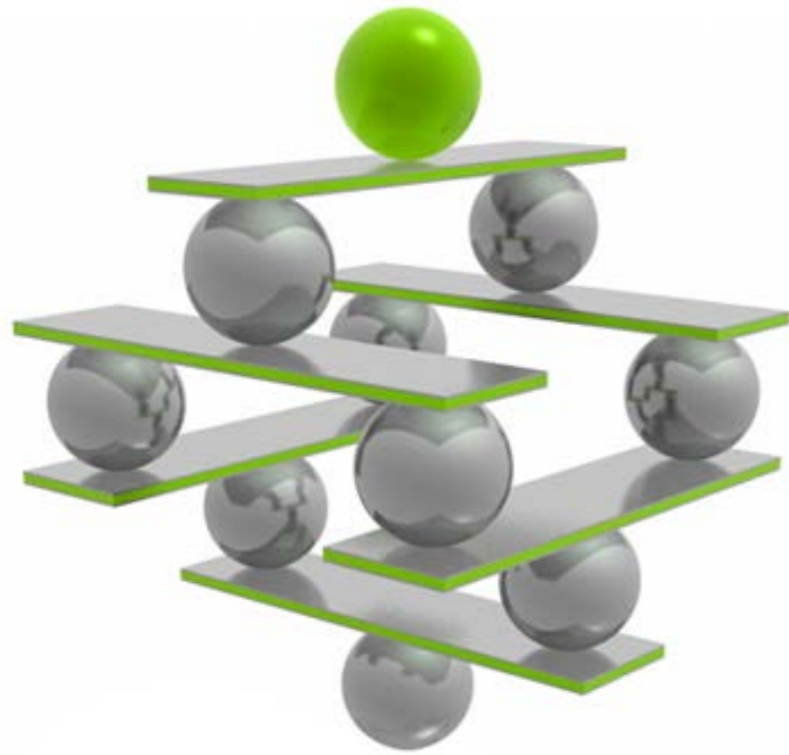

We recognise that the value from adopting such methods as VDC and BIM protocol must benefit the design practice as well as the client project delivery.

The added efficiencies must demonstrate improvement in maintaining planned output with allocation of resource and cost.

However fees are more often eroded through unplanned post tender project involvement due to revision and rework.

This rework is commonly proportional to the lack of detail and accuracy of information at conceptual design stage which then becomes flushed out as construction teams produce working drawing information.

Therefore a solution would be to narrow the scope gap during the initial design stage to agreed but coordinated levels of detail (LOD).

A VDC 3D model to LOD300 will significantly improve the accuracy of the design concept scheme and minimise the unplanned involvement that erodes fee recovery and disrupts internal business resource planning.



Project change can impact consultant practices in a number of ways regardless of derogated responsibility, such as.....

Erosion of fees through....

Unplanned meetings.

Responding to increased RFI's and TQ's.

Revision of drawings.

Unplanned visits to site.

Unsupported value engineering exercises to support unforeseen increased cost to client.

Damage to business due to....

Loss of reputation as a result of increased costs to client.

Financial losses due to fee erosion.

Reduced business capacity due to unplanned use of resource.



Benefits to the business:

Better equipped to drive design coordination with the clients design team.

More efficient use of design professionals without dilution of time through drawing activities.

Increased coordination between disciplines.

Avoiding unpaid value engineering exercises caused by inflated tender prices driven by lack of detail/ coordination.

Reducing revision of drawings.

Reduced time spent responding to RFI's /TQ's from contractors.

Reduce site visits to address coordination.

Reduce unplanned meetings due to site issues.

Reduce involvement in change management and variation cost management/advice.

Broaden market opportunity.

Increased business offer to clients:

Increasing project cost certainty.

Minimising change.

Demonstrating greater collaboration.

Reducing tender periods due to increased detail

Reducing pre-construction lead-in due to model transfer to construction team.

Reducing site delays due to early coordination.

Improve project deadline and schedule.

Repeat business.



We are looking to engage with forward looking business's to create continuous working relationships that build trust, understanding and continuous improvement.

Should you consider this a match with your business we would be delighted to meet and discuss how Bimtech could provide support and integration with your team to increase business capability.

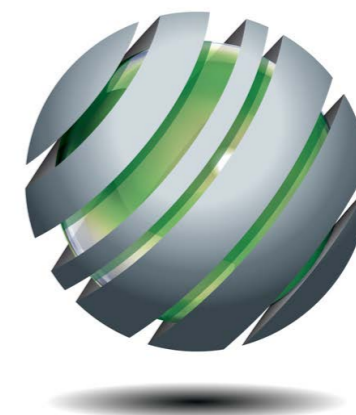

BIMTech
ENGINEERING

Services
BIM Level 2 compliance
Collaborative working environments
COBie Compliant Data Drops
Design Development
Virtual Coordination

3D Virtual Modelling
4D
Trimble interface
Clash Detection
Laser scanning
Multi-Disciplinary Models



BIMTech